



**OFFICIAL MINUTES OF THE OXFORD MAYOR AND COUNCIL MEETING  
WORK SESSION (FOR DECEMBER 2018)  
MONDAY, JANUARY 7, 2019 – 6:00 PM  
CITY HALL**

**MEMBERS PRESENT:** Mayor Jerry D. Roseberry; Councilmembers: Jim Windham; George Holt; David Eady; Mike Ready, Jeff Wearing and Sarah Davis.

**OTHERS PRESENT:** Matt Pepper, City Manager; Dave Harvey, Chief; Lauran Willis, City Clerk; Jody Reid, Utility Superintendent; Officer Caleb Jackson, Huie Stewart, Hoyt Oliver, Mike McQuaide, Peggy Madden, Darryl Welch, with the Covington News, David Huber MD, James Wadley from Oxford College, Reverend Tom Johnson, Anderson Wright, Randy Simon from Oxford College, Lisa Williams, Jason Thomas, Laura Gafnea from Oxford College, Nicholas Cole and Art Vinson.

The meeting was called to order by Mayor Jerry D. Roseberry.

**Agenda** (Attachment A)

**1. Mayor's Announcements**

Chief Dave Harvey introduced the new police officer Caleb Jackson.

**2. Wesley Street and Pierce Street Road Improvements Discussion**

Randy Simon from Oxford College presented their draft site plans for road improvements to the Wesley Street and Pierce Street intersection. Attachment B

**3. Moore Street Sidewalk Civil Plans**

Reverend Tom Johnson addressed council with concerns relating to the sidewalk and concluded with his approval of the civil plans presented to him in conjunction to his property. After further discussion, City Manager Matt Pepper was instructed to continue working with the City Engineer to obtain a cost estimate on continuing the sidewalk to Emory Street. Attachment C

**4. E. Clark Street Extension**

This project is on hold pending completion of the Asbury Street Park and the Emory Street Sewer project.

**5. 107 W. Clark Street Renovation Project**

Councilmember Jeff Wearing said that he met with the contractor today along with City Manager Matt Pepper and Utility Superintendent Jody Reid and found a few items that need completion before signing off on the payment of the invoice.

**6. Change Order for Asbury Street Park**

Contractor Huie Stewart said that during the grading for the park, they discovered ground water in the area where the pavilion will be located. The city engineer recommended that we correct the issue with fill rock and the creation of a drain to guide the water to the invert under Emory Street. This resulted in an additional cost of \$22,360.00. Attachment D

**7. Changer Order for Emory Street Sewer Project**

City Manager Matt Pepper said that during the construction of the sewer main, the contractor encountered rock at the intersection of Hamill Street and Emory Street. In order to continue laying the sewer main, the contractor had to remove 92 cubic yards of rock. This resulted in an addition cost of \$11,040.00. Attachment E

**8. MEAG Power Purchase Agreement**

Mayor Roseberry said the city will need to purchase 1004 kW to meet our reserve capacity for 2019. We recommend that Council designate Municipal Electric Authority of Georgia (MEAG) to acquire the necessary resources to meet the city's reserve capacity needs. Attachment F

**9. Planning Commission Vacancy**

City Manager Matt Pepper said that Aaron Robinson is moving and will leave a vacancy on the Planning Commission. He requested council discuss replacement to fill his remaining one year.

Meeting Adjourned at 6:42 pm.

Respectfully Submitted,



Lauran Willis, MMC/FOA  
City Clerk

**OXFORD MAYOR AND COUNCIL  
WORK SESSION  
MONDAY, JANUARY 7, 2019 – 6:00 P.M.  
CITY HALL  
A G E N D A**

1. **Mayor's Announcements**
2. \* **Wesley Street and Pierce Street Road Improvements Discussion** – Oxford College would like to discuss their draft site plans for road improvements to the Wesley Street and Pierce Street intersection. We have attached a site plan for the project.
3. \* **Moore Street Sidewalk Civil Plans** – Council will review the civil plans to install a sidewalk along the south side of Moore Street from Longstreet Circle to Emory Street (Hwy 81).
4. **E. Clark Street Extension** – Council will discuss the project to redevelop the infrastructure along E. Clark Street.
5. **107 W. Clark Street Renovation Project** – The *ad hoc* Yarbrough House Renovation Committee will report on the progress of the 107 W. Clark Street Renovation Project.
6. \* **Change Order for Asbury Street Park** – During grading for the park, the contractor noticed ground water in the area where the pavilion will be located. The city engineer recommended that we correct the issue with fill rock and the creation of a drain to guide the water to the invert under Emory Street. We have attached the change order for this work.
7. \* **Change Order for Emory Street Sewer Project** – During construction of the sewer main, the contractor encountered rock at the intersection of Hamill Street and Emory Street. In order to continue laying the sewer main, the contractor had to remove 92 cubic yards of rock. We have attached the change order for this work.
8. \* **MEAG Power Purchase Agreement** – The city will need to purchase 1004 kW to meet our required reserve capacity for 2019. We recommend that Council designate Municipal Electric Authority of Georgia to acquire the necessary resources to meet the city's reserve capacity needs. We have attached the contract with the City of Washington.
9. **Planning Commission Vacancy** – Council will discuss filling the vacancy on the Planning Commission created by the departure of Aaron Robinson.

\*Attachments







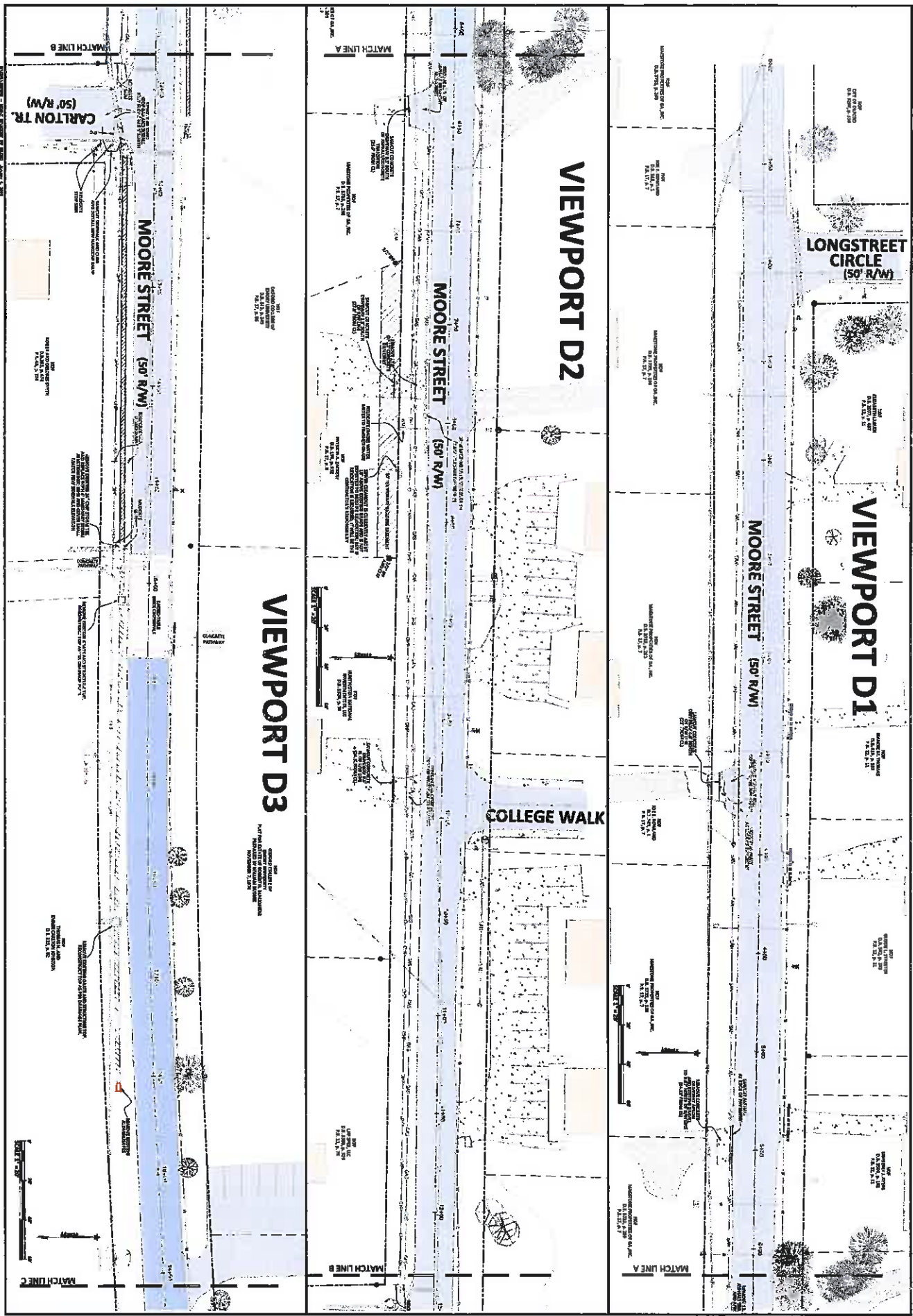

Rev	Revision Description	Date
0	Initial Issue	04/04/20

Sheet No. **3**

**Moore Street Sidewalk**  
Oxford, Newton County, Georgia

**DEMOLITION PLAN  
PANELS D1-D3**



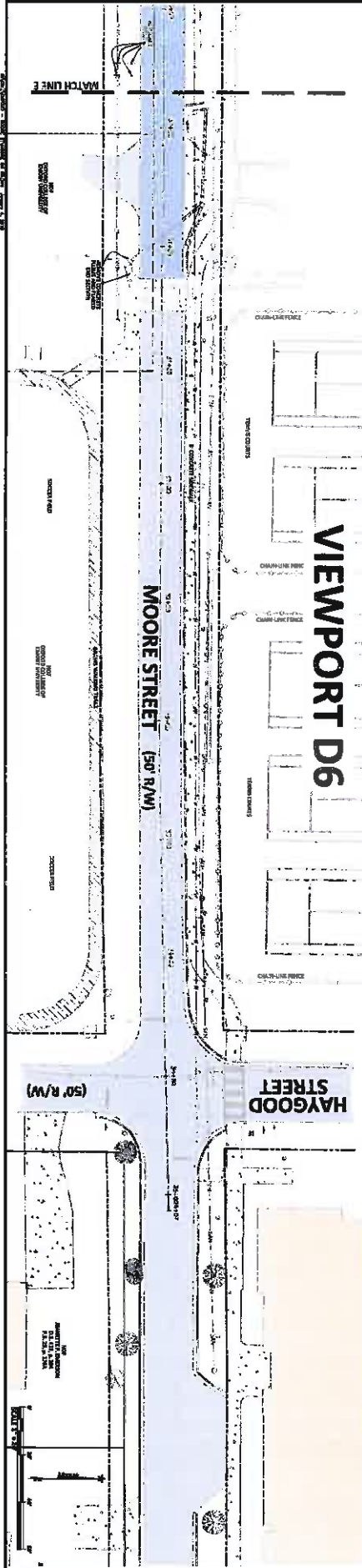
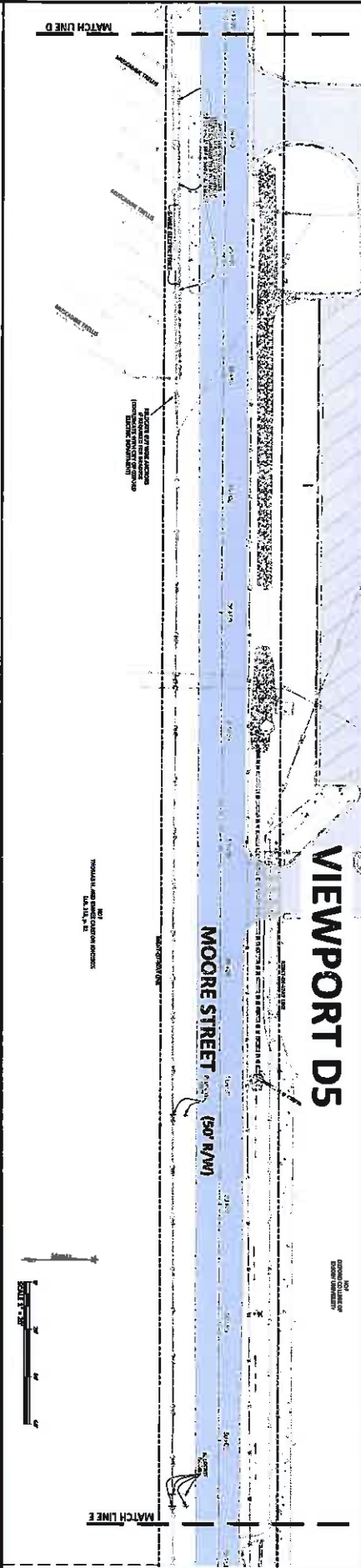
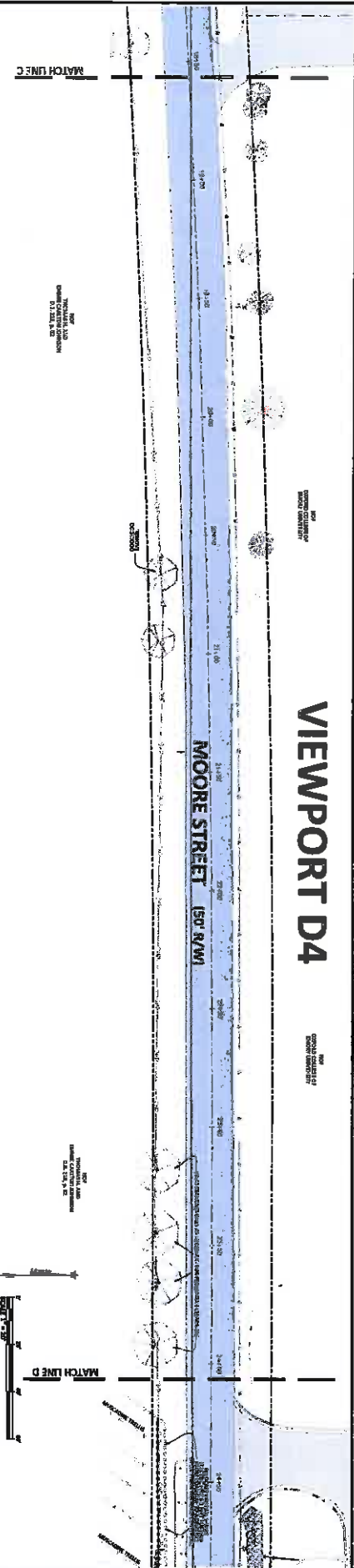

No.	Revision Description	Date
0	Initial Issue	12/14/12

Sheet No. 4

Moore Street Sidewalk  
Oxford, Newton County, Georgia

DEMOLITION PLAN  
PANELS D4-D6





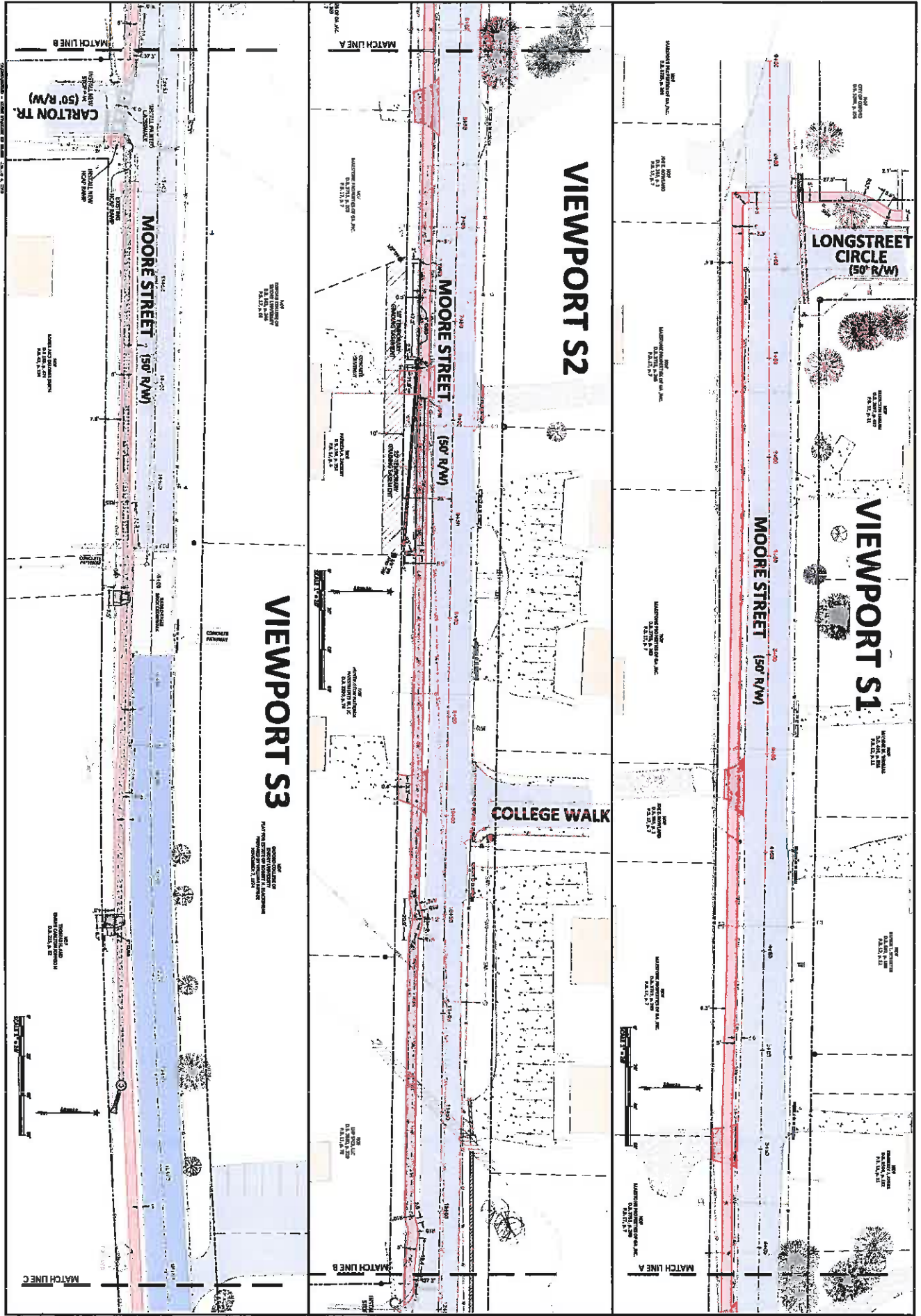

Sheet No.	Date	Revision Description
5	11/01/23	Initial Issue

**Moore Street Sidewalk**  
Oxford, Newton County, Georgia

**SITE PLAN**  
**PANELS S1-S3**



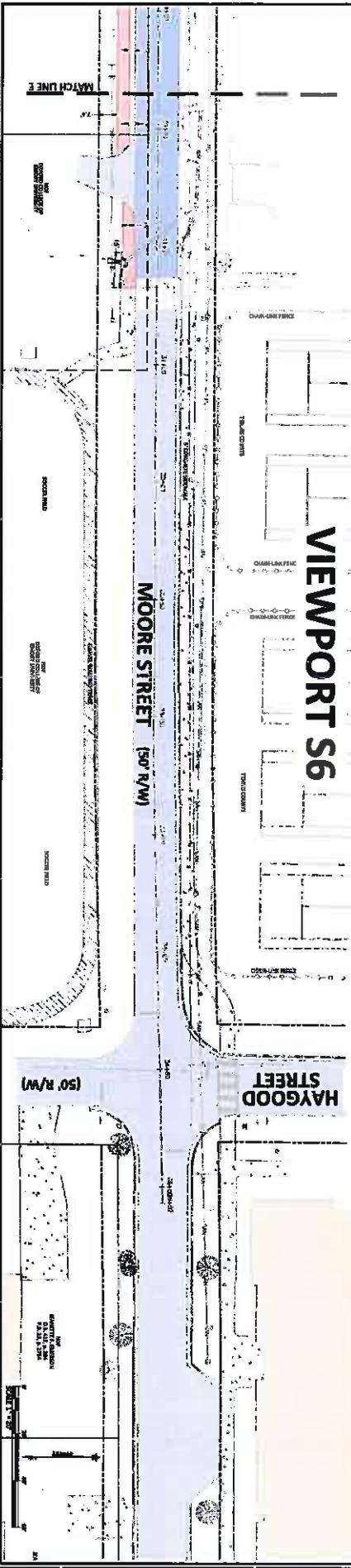
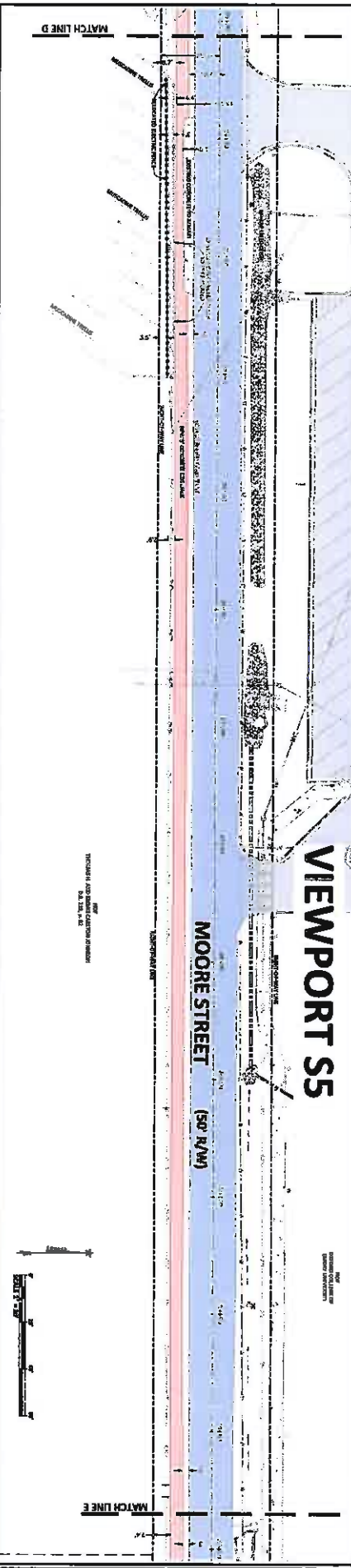
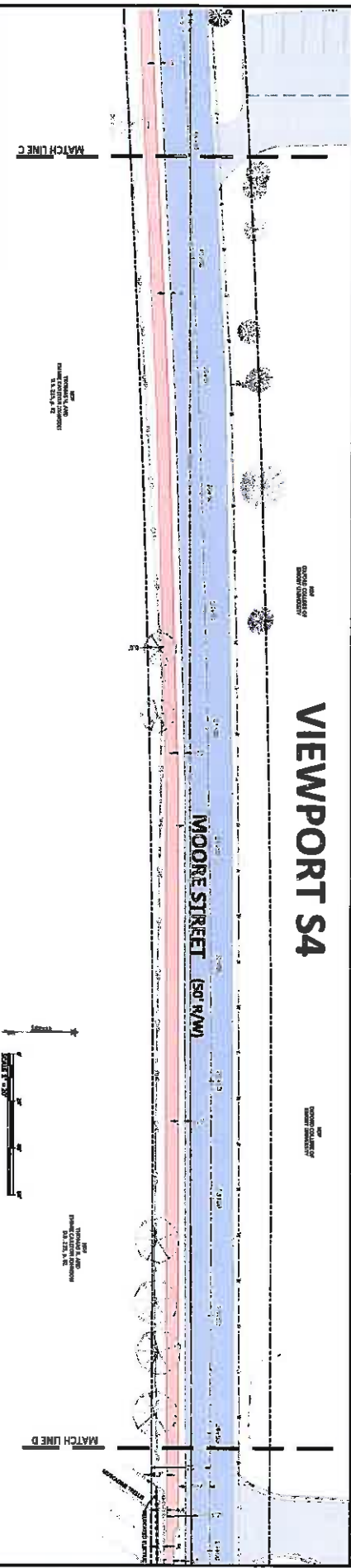

**VIEWPORT S4**

**VIEWPORT S5**

**VIEWPORT S6**

MOORE STREET (50' R/W)

MOORE STREET (50' R/W)

MOORE STREET (50' R/W)

HAYGOOD STREET (50' R/W)

(50' R/W)

Sheet No. 6

Rev	Revision Description	Date
1	Initial Issue	02/04/21

Moore Street Sidewalk  
Oxford, Newton County, Georgia

**SITE PLAN  
PANELS S4-S6**



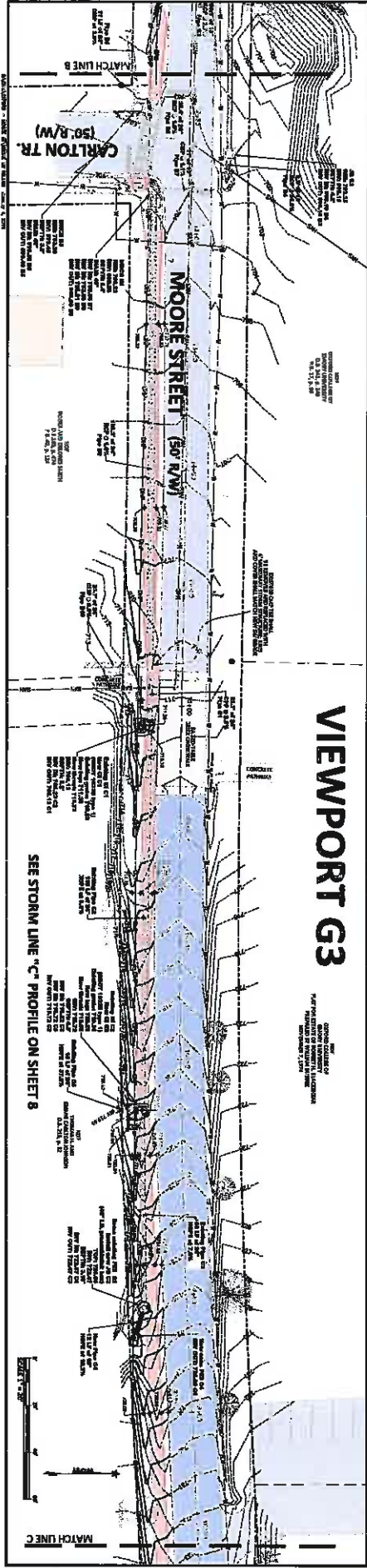
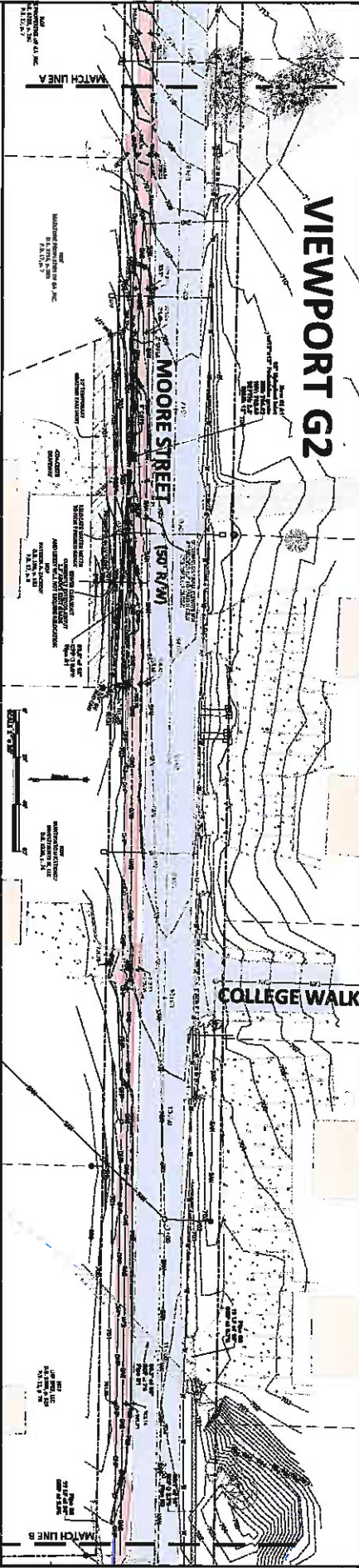
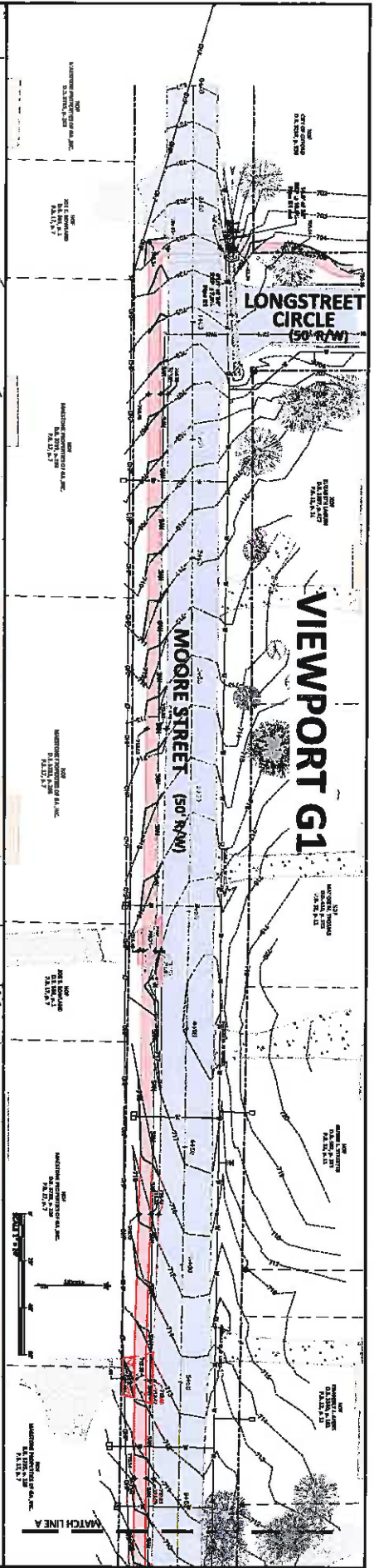

Rev	Revisions Description	Date
0	Initial Issue	08/24/22
1		
2		
3		
4		
5		
6		
7		

**Moore Street Sidewalk**  
Oxford, Newton County, Georgia

**GRADING AND DRAINAGE PLAN**  
**VIEWPORTS G1-G3**



# VIEWPORT G4

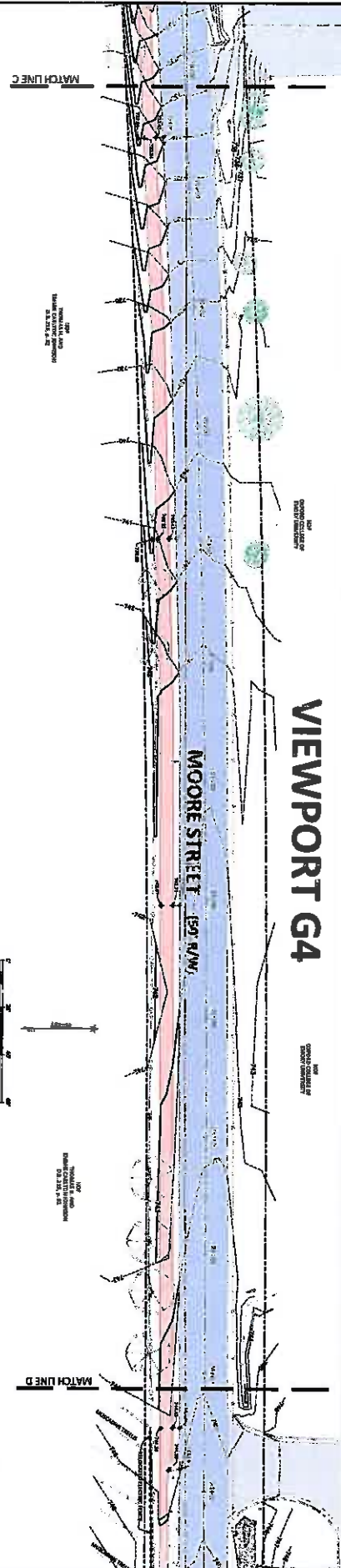

# VIEWPORT G5

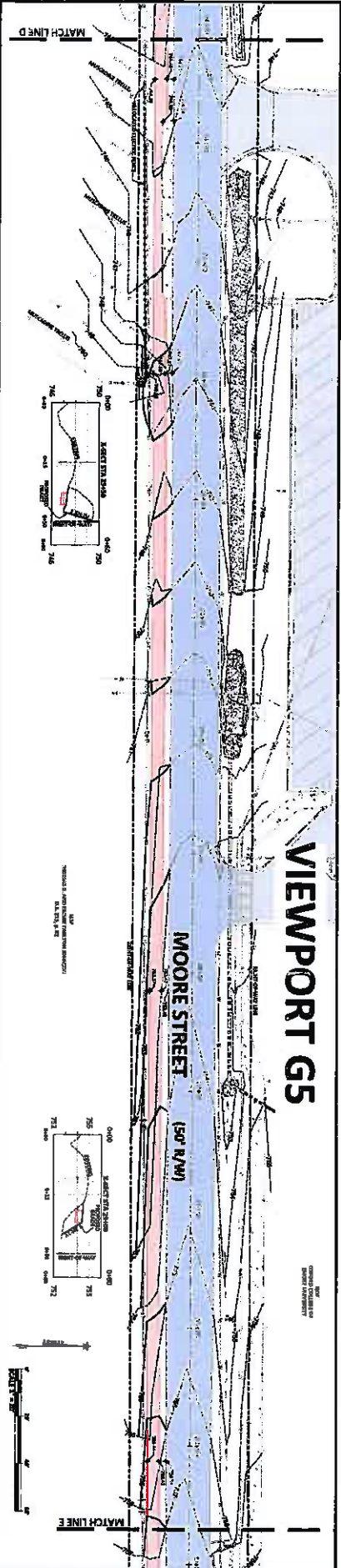

# VIEWPORT G6

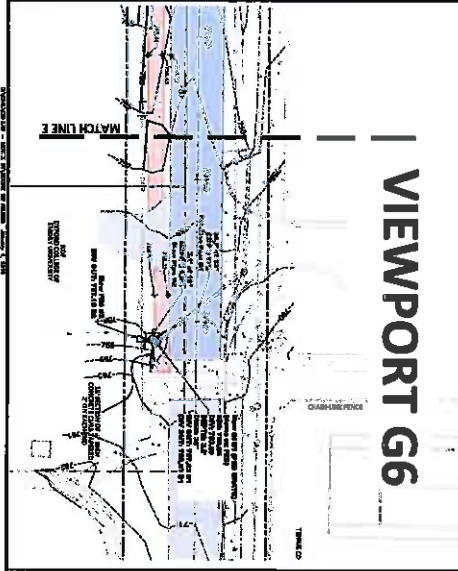

# STORM LINE C

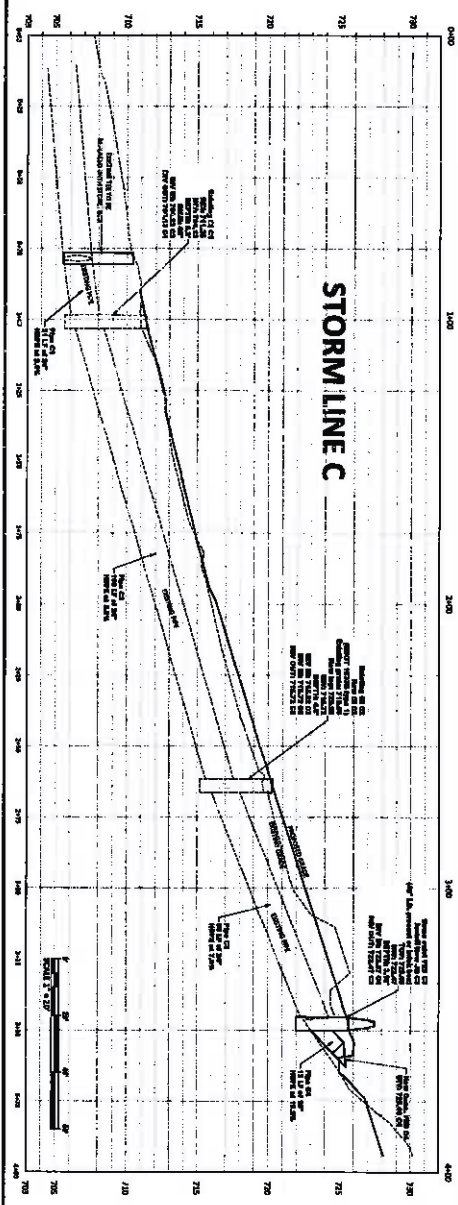

Sheet No.	Revision	Description	Date
8			

Moore Street Sidewalk  
Oxford, Newton County, Georgia

GRADING AND DRAINAGE PLAN  
VIEWPORTS G4-G6



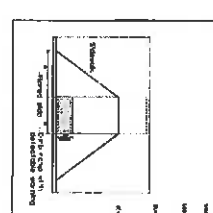
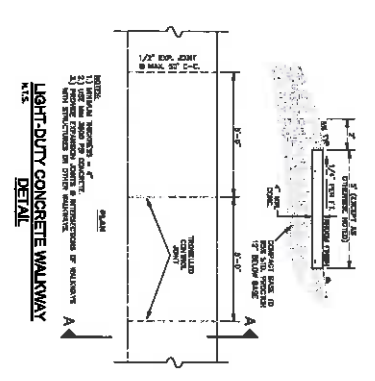
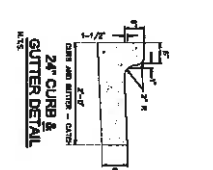
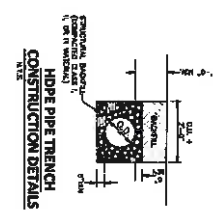
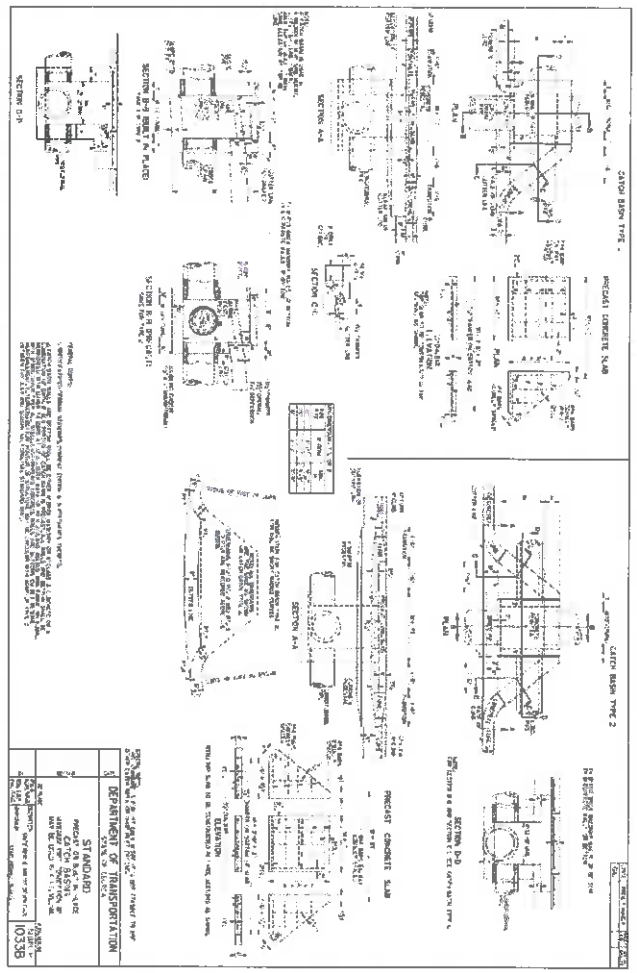

THE CURB AND GUTTER SHALL BE CONCRETE AND SHALL BE CAST IN PLACE. THE CURB SHALL BE 4'-0\"/>

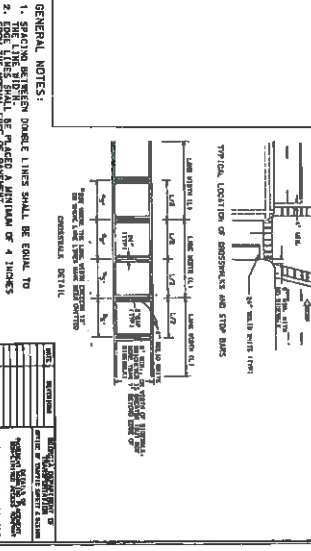
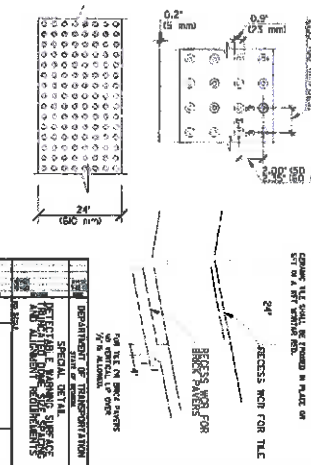

Rev	Revision Description	Date
1	Initial Issue	01/11/11

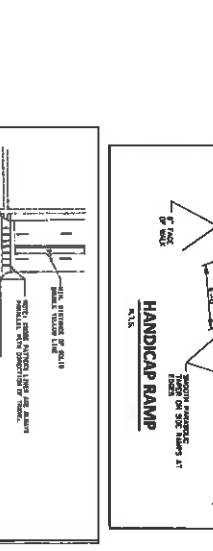

GENERAL NOTES:  
 1. SLOPING REINFORCING BARS SHALL BE PLACED AT A MINIMUM OF 4 INCHES FROM THE BOTTOM OF THE CONCRETE.  
 2. REINFORCING BARS SHALL BE PLACED AT A MINIMUM OF 4 INCHES FROM THE TOP OF THE CONCRETE.



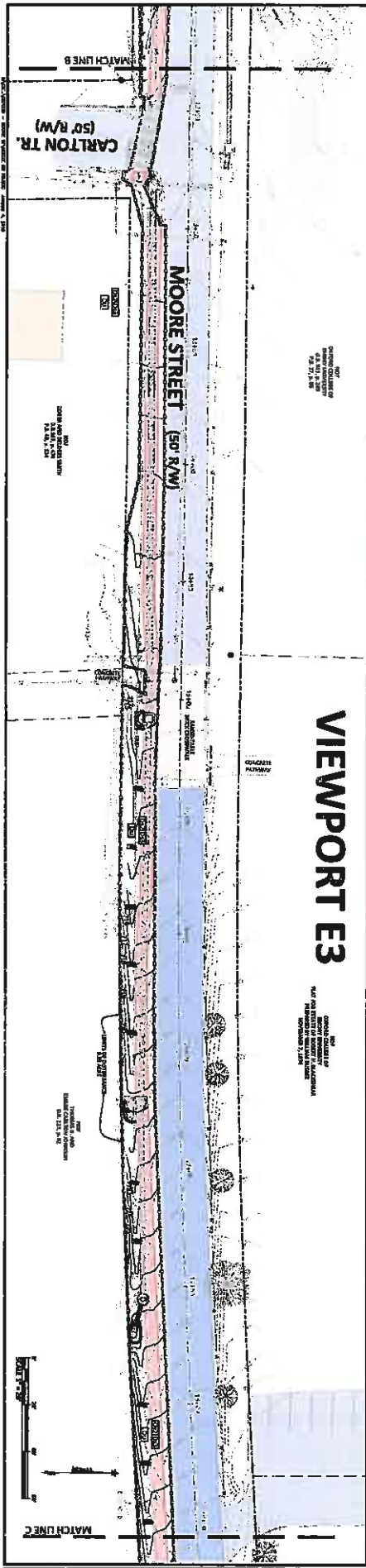
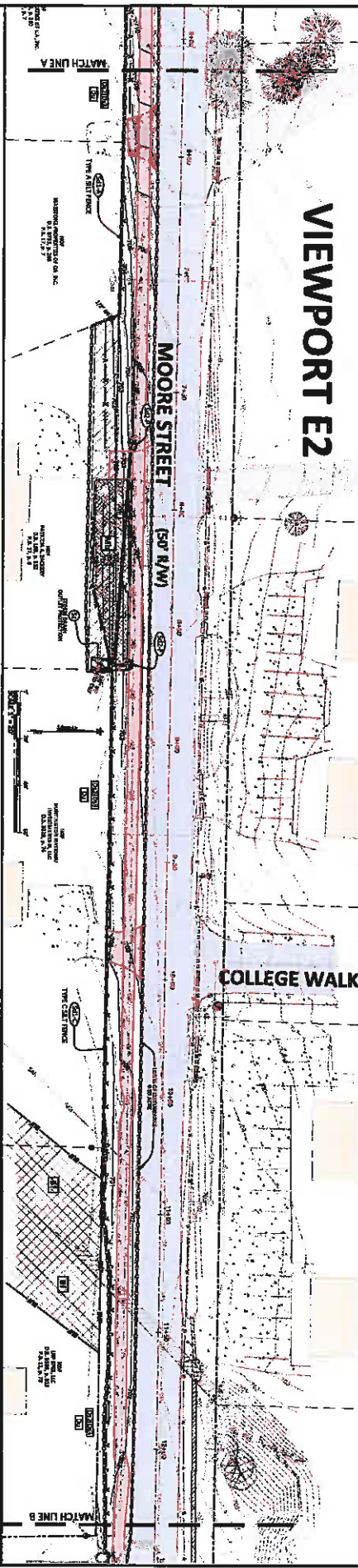
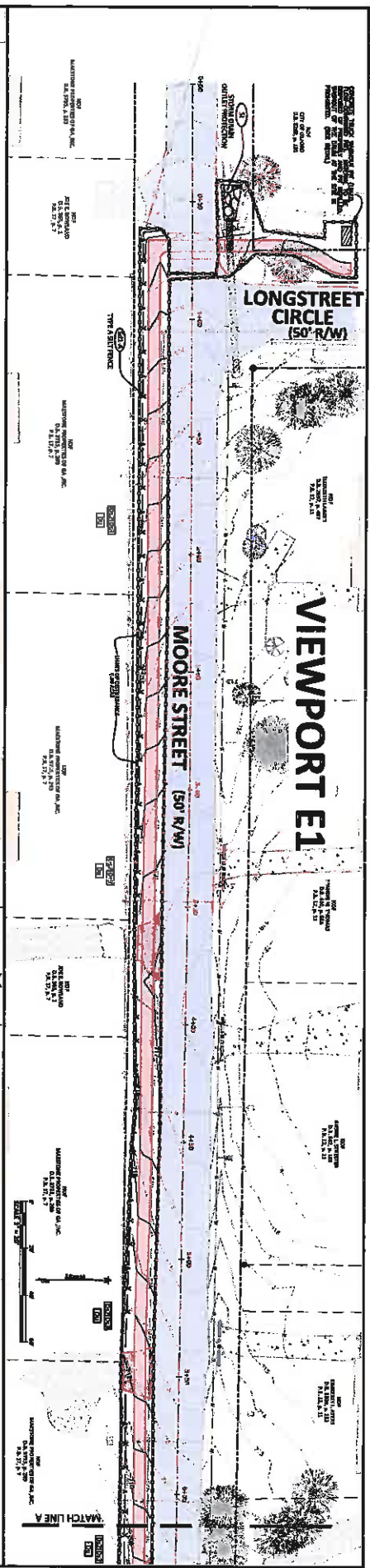

Rev	Description	Date
0	Initial Issue	02/04/17

Sheet No. 10

Moore Street Sidewalk  
Oxford, Newton County, Georgia

**EROSION CONTROL PLAN**  
**VIEWPORTS E1-E3**



# VIEWPORT E4

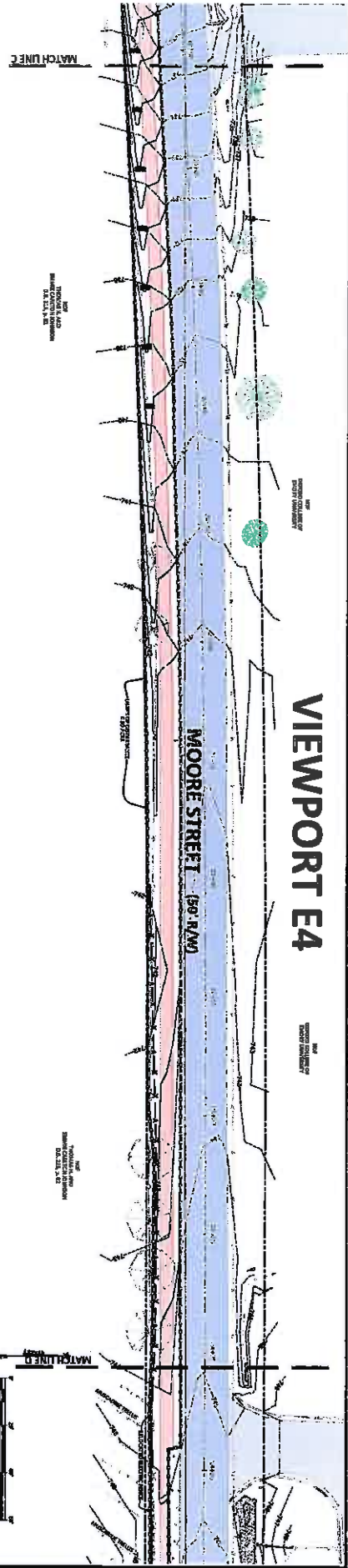

# VIEWPORT E5

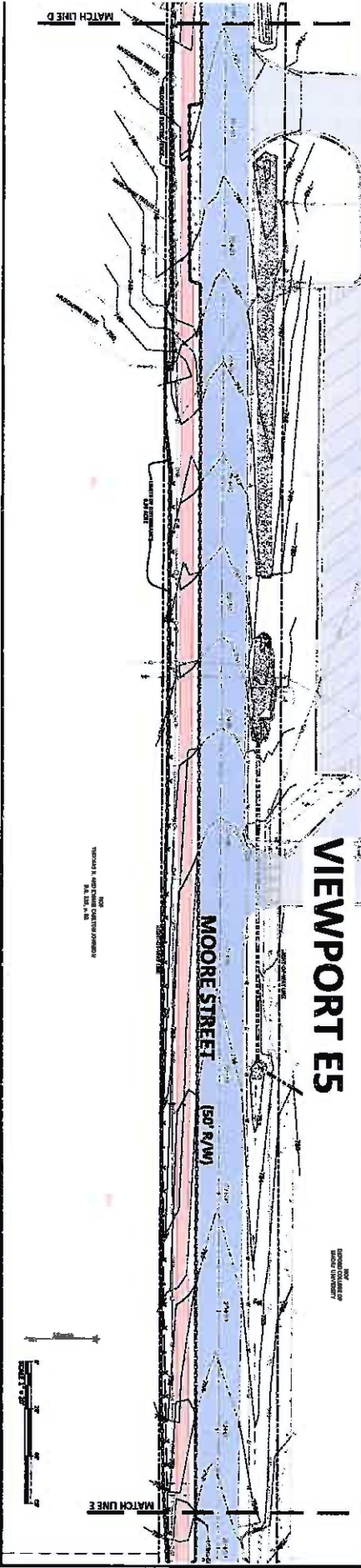

# VIEWPORT E6

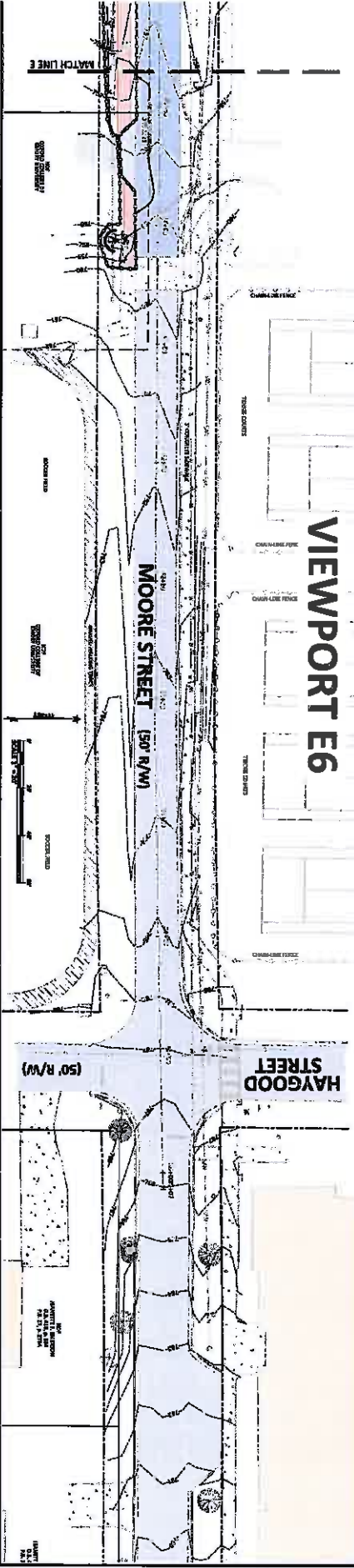

## EROSION CONTROL PLAN VIEWPORTS E4-E6

Moore Street Sidewalk  
Oxford, Newton County, Georgia

Rev	Revision Description	Date
0	MFC Issue	12/04/23

**GENERAL SITE INFORMATION:**

1. PROJECT NAME: **MOORE STREET SIDEWALK**  
 2. PROJECT LOCATION: **OXFORD, GEORGIA**  
**PROJECT NARRATIVE DESCRIPTION:**  
 THE PROJECT IS A SIDEWALK IMPROVEMENT PROJECT ALONG MOORE STREET IN OXFORD, GEORGIA. THE PROJECT AREA IS APPROXIMATELY 1.5 ACRES IN SIZE AND IS BOUNDED BY [REDACTED] TO THE NORTH, [REDACTED] TO THE SOUTH, [REDACTED] TO THE WEST, AND [REDACTED] TO THE EAST. THE PROJECT WILL INVOLVE THE CONSTRUCTION OF A NEW SIDEWALK, CURB, AND GUTTER SYSTEM, AS WELL AS THE REPAIR AND REPAVING OF EXISTING SIDEWALKS AND DRIVEWAYS. THE PROJECT WILL BE CONDUCTED IN PHASES, WITH THE FIRST PHASE BEING THE CONSTRUCTION OF THE SIDEWALK AND CURB ALONG THE WEST SIDE OF MOORE STREET FROM [REDACTED] TO [REDACTED].

**RECEIVING WATERS:**

1. RECEIVING WATER BODY: **MOORE CREEK**  
 2. RECEIVING WATER BODY TYPE: **WATERWAY**  
 3. RECEIVING WATER BODY USE: **RECREATION, FISHING, AND WILDLIFE**

**ADDITIONAL MEASURES:**

1. **STABILIZED EXPOSED DISTURBANCE:** ALL EXPOSED DISTURBED AREAS SHALL BE STABILIZED WITH SEEDING, MULCHING, OR EROSION CONTROL MATS WITHIN 30 DAYS OF COMPLETION OF THE DISTURBANCE. THE STABILIZATION SHALL BE MONITORED AND MAINTAINED THROUGHOUT THE CONSTRUCTION PERIOD.

**POLLUTION CONTROL NOTES:**

1. **SPILL CLEANUP AND CONTROL PRACTICES:** ALL SPILLS OF OIL, GREASE, OR OTHER HAZARDOUS MATERIALS SHALL BE CLEANED UP IMMEDIATELY AND PROPERLY. THE CLEANUP SHALL BE DOCUMENTED AND REPORTED TO THE LOCAL HEALTH DEPARTMENT AND THE STATE DEPARTMENT OF ENVIRONMENTAL PROTECTION. ALL SPILLS SHALL BE CLEANED UP WITHIN 24 HOURS OF OCCURRENCE.

**HAZARDOUS WASTES:**

1. **HAZARDOUS WASTE IDENTIFICATION:** ALL HAZARDOUS WASTES SHALL BE IDENTIFIED AND PROPERLY HANDLED AND DISPOSED. THE IDENTIFICATION SHALL BE BASED ON THE MATERIAL SAFETY DATA SHEET (MSDS) FOR EACH MATERIAL. ALL HAZARDOUS WASTES SHALL BE STORED IN APPROVED CONTAINERS AND Labeled with the appropriate hazard labels and placards.

**EROSION CONTROL SEQUENCING NARRATIVE:**

1. **EROSION CONTROL SEQUENCING:** THE EROSION CONTROL MEASURES SHALL BE INSTALLED AND MAINTAINED THROUGHOUT THE CONSTRUCTION PERIOD. THE SEQUENCING OF THE EROSION CONTROL MEASURES SHALL BE BASED ON THE PHASES OF THE PROJECT AND THE TYPE OF DISTURBANCE. THE EROSION CONTROL MEASURES SHALL BE MONITORED AND MAINTAINED THROUGHOUT THE CONSTRUCTION PERIOD.

**AFTER INSTALLATION OR BEFORE DEMOLITION PRACTICES:**

1. **AFTER INSTALLATION OR BEFORE DEMOLITION:** ALL EROSION CONTROL MEASURES SHALL BE MAINTAINED THROUGHOUT THE CONSTRUCTION PERIOD. THE MEASURES SHALL BE REMOVED IMMEDIATELY UPON COMPLETION OF THE PROJECT OR BEFORE DEMOLITION OF THE PROJECT. THE REMOVAL SHALL BE DOCUMENTED AND REPORTED TO THE LOCAL HEALTH DEPARTMENT AND THE STATE DEPARTMENT OF ENVIRONMENTAL PROTECTION.

**EROSION & SEDIMENT CONTROL NOTES:**

1. **EROSION & SEDIMENT CONTROL:** ALL EROSION & SEDIMENT CONTROL MEASURES SHALL BE INSTALLED AND MAINTAINED THROUGHOUT THE CONSTRUCTION PERIOD. THE MEASURES SHALL BE MONITORED AND MAINTAINED THROUGHOUT THE CONSTRUCTION PERIOD. THE MEASURES SHALL BE REMOVED IMMEDIATELY UPON COMPLETION OF THE PROJECT OR BEFORE DEMOLITION OF THE PROJECT. THE REMOVAL SHALL BE DOCUMENTED AND REPORTED TO THE LOCAL HEALTH DEPARTMENT AND THE STATE DEPARTMENT OF ENVIRONMENTAL PROTECTION.

**GENERAL NOTES:**

1. **GENERAL NOTES:** ALL CONSTRUCTION SHALL BE IN ACCORDANCE WITH THE LATEST EDITIONS OF THE GEORGIA CONSTRUCTION CODE AND THE LATEST EDITIONS OF THE INTERNATIONAL BUILDING CODE. ALL CONSTRUCTION SHALL BE SUBJECT TO THE INSPECTION AND APPROVAL OF THE LOCAL HEALTH DEPARTMENT AND THE STATE DEPARTMENT OF ENVIRONMENTAL PROTECTION.

**CONTRACTOR'S OBLIGATIONS:**

1. **CONTRACTOR'S OBLIGATIONS:** THE CONTRACTOR SHALL BE RESPONSIBLE FOR THE INSTALLATION, MAINTENANCE, AND REMOVAL OF ALL EROSION & SEDIMENT CONTROL MEASURES. THE CONTRACTOR SHALL BE RESPONSIBLE FOR THE MONITORING AND MAINTENANCE OF ALL EROSION & SEDIMENT CONTROL MEASURES THROUGHOUT THE CONSTRUCTION PERIOD.

**NOTE: THE AREA OF DISTURBANCE FOR THIS PROJECT IS LESS THAN THE 1 ACRE THRESHOLD REQUIRING PREPARATION AND SUBMITTAL OF EROSION CONTROL PLANS AND FOR NPDES PERMITTING AND MONITORING.**

THE CONTRACTOR SHALL ARRANGE FOR PORTABLE TOILETS DURING CONSTRUCTION PHASE OF WORK. SANITARY SEWER SYSTEM DESCRIBED ON SHEETS 5 AND 12 SHALL BE INSTALLED TO ACCOMMODATE SEWAGE TREATMENT OF THE COMPLETE DEVELOPMENT [CITY OF OXFORD].

**24 HOUR CONTACT PERSON:**

PHONE: (404) 775-6319

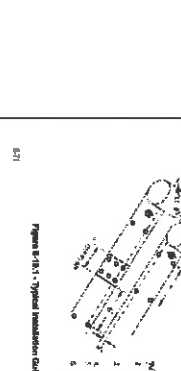
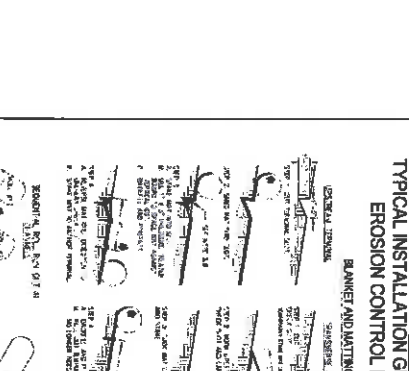

**CONSTRUCTION ACTIVITY SCHEDULE**

DATE	ACTIVITY	STATUS
01/15/2024	MOORE STREET SIDEWALK CONSTRUCTION	PLANNED
02/15/2024	MOORE STREET SIDEWALK CONSTRUCTION	PLANNED
03/15/2024	MOORE STREET SIDEWALK CONSTRUCTION	PLANNED
04/15/2024	MOORE STREET SIDEWALK CONSTRUCTION	PLANNED
05/15/2024	MOORE STREET SIDEWALK CONSTRUCTION	PLANNED
06/15/2024	MOORE STREET SIDEWALK CONSTRUCTION	PLANNED
07/15/2024	MOORE STREET SIDEWALK CONSTRUCTION	PLANNED
08/15/2024	MOORE STREET SIDEWALK CONSTRUCTION	PLANNED
09/15/2024	MOORE STREET SIDEWALK CONSTRUCTION	PLANNED
10/15/2024	MOORE STREET SIDEWALK CONSTRUCTION	PLANNED
11/15/2024	MOORE STREET SIDEWALK CONSTRUCTION	PLANNED
12/15/2024	MOORE STREET SIDEWALK CONSTRUCTION	PLANNED

**Dust Control on Disturbed Areas**

**DEFINITION:** Controlling surface soil and sediment at sites on construction sites, roads, and disturbed areas.

**PURPOSE:** To prevent erosion and the movement of dust from exposed soil surfaces. To prevent the movement of sediment and sediment-laden runoff from exposed soil surfaces. To prevent the movement of sediment and sediment-laden runoff from exposed soil surfaces.

**CONDITIONS:** This practice is applicable to areas subject to erosion and sedimentation. This practice is applicable to areas subject to erosion and sedimentation. This practice is applicable to areas subject to erosion and sedimentation.

**METHOD AND MATERIALS:** A temporary surface cover, such as mulch, straw, or hay, shall be applied to exposed soil surfaces. A temporary surface cover, such as mulch, straw, or hay, shall be applied to exposed soil surfaces. A temporary surface cover, such as mulch, straw, or hay, shall be applied to exposed soil surfaces.

**SILT STOP ROCK BAG**

**Sdz-P**

APPROXIMATE DIMENSIONS: 36 IN. x 36 IN. x 3 IN.

CONING MATS: 36 IN. x 36 IN. x 3 IN.

NUMBER OF ROCK BAGS PER LINE: 1

DATE: January 31, 2024

CODE	PI	DESCRIPTION	SYMBOL
Sdz-A	1	SEDIMENT BARRIER (TYPE 'A' SILT FENCE)	X-A
Sdz-B	1	SEDIMENT BARRIER (TYPE 'B' SILT FENCE)	X-B
Sdz-C	1	SEDIMENT BARRIER (TYPE 'C' SILT FENCE)	X-C
Sdz-D	2	INLET SEDIMENT TRAP (TYPE 'D' SILT FENCE)	X-D
Sdz-E	3	CONC. INLET PROTECTION	X-E
Rd	1	ROAD FILTER DAW	X-F
Gd-S	2	STONE DAW FILTER	X-G
Gd-H	2	HAY DALE DAW FILTER	X-H
Gd-V	2	VEGETATIVE SWALE	X-I
Sk	2	FLOATING SKIMMER	X-J
Dd	ALL	DIST. CONTROL	X-K
Sz	2	STEEL DRAIN OUTLET PROTECTION	X-L
Co	1	CONSTRUCTION DIRT	X-M
MIB	2	MATTING MATERIAL (SEE SPECIAL SHEET)	X-N
P	2	PAPER BARRIERS	X-O
Tp	2	TOPSOILING	X-P
SdS	2	TRAIL SEDIMENT MATS	X-Q
BR	1	UNDISTURBED BUFFER	X-R
Dd-1	2	INSTALLED WITH MULCHING ONLY	X-S
Dd-2	2	INSTALLED WITH MULCHING AND SEEDING	X-T
Dd-3	2	TEMPORARY SEEDING	X-U
Dd-4	2	PERMANENT VEGETATION	X-V
Dd-5	2	EMERGENCY HI-RAP OVERFLOW PROTECTION	X-W
RR	1	RETENTION	X-X

**24 HOUR CONTACT PERSON:** (404) 775-6319

**MOORE STREET SIDEWALK**  
 Oxford, Newton County, Georgia

**EROSION CONTROL CHECKLIST AND SCHEDULE**

**JORDAN ENGINEERING & CONSTRUCTION**  
 Last Planets - Through to the Client

**Sheet No. 12**



**37) DISTURBED AREA STABILIZATION (W/TEMPORARY SEEDING)**

1. The contractor shall stabilize all areas of exposed soil, rock, or other material that is susceptible to erosion. The contractor shall use the following methods and materials to stabilize the exposed areas:

1. Temporary seeding shall be used on all areas of exposed soil, rock, or other material that is susceptible to erosion. The contractor shall use the following methods and materials to stabilize the exposed areas:
2. The contractor shall use a minimum of 100 lbs of seed per 1000 sq ft of exposed area.
3. The contractor shall use a minimum of 100 lbs of straw per 1000 sq ft of exposed area.
4. The contractor shall use a minimum of 100 lbs of mulch per 1000 sq ft of exposed area.

**38) DISTURBED AREA STABILIZATION (W/PERMANENT SEEDING)**

1. The contractor shall stabilize all areas of exposed soil, rock, or other material that is susceptible to erosion. The contractor shall use the following methods and materials to stabilize the exposed areas:

1. Permanent seeding shall be used on all areas of exposed soil, rock, or other material that is susceptible to erosion. The contractor shall use the following methods and materials to stabilize the exposed areas:
2. The contractor shall use a minimum of 100 lbs of seed per 1000 sq ft of exposed area.
3. The contractor shall use a minimum of 100 lbs of straw per 1000 sq ft of exposed area.
4. The contractor shall use a minimum of 100 lbs of mulch per 1000 sq ft of exposed area.

**TEMPORARY SEEDING AND FERTILIZING CHART**

SEED	FERTILIZER
100 lbs	100 lbs
200 lbs	200 lbs
300 lbs	300 lbs
400 lbs	400 lbs
500 lbs	500 lbs
600 lbs	600 lbs
700 lbs	700 lbs
800 lbs	800 lbs
900 lbs	900 lbs
1000 lbs	1000 lbs

**39) EROSION CONTROL MATTING**

1. The contractor shall stabilize all areas of exposed soil, rock, or other material that is susceptible to erosion. The contractor shall use the following methods and materials to stabilize the exposed areas:

1. Erosion control matting shall be used on all areas of exposed soil, rock, or other material that is susceptible to erosion. The contractor shall use the following methods and materials to stabilize the exposed areas:
2. The contractor shall use a minimum of 100 lbs of matting per 1000 sq ft of exposed area.
3. The contractor shall use a minimum of 100 lbs of straw per 1000 sq ft of exposed area.
4. The contractor shall use a minimum of 100 lbs of mulch per 1000 sq ft of exposed area.

**40) TACKERS AND BARRIERS**

1. The contractor shall stabilize all areas of exposed soil, rock, or other material that is susceptible to erosion. The contractor shall use the following methods and materials to stabilize the exposed areas:

1. Tackers and barriers shall be used on all areas of exposed soil, rock, or other material that is susceptible to erosion. The contractor shall use the following methods and materials to stabilize the exposed areas:
2. The contractor shall use a minimum of 100 lbs of tackers per 1000 sq ft of exposed area.
3. The contractor shall use a minimum of 100 lbs of barriers per 1000 sq ft of exposed area.

**THE INSTALLATION OF EROSION CONTROL MEASURES AND PRACTICES SHALL OCCUR BEFORE TO AND CONCURRENT WITH LAND RESTORATION ACTIVITIES.**

**41) DISTURBED AREA STABILIZATION (W/PERMANENT SEEDING)**

1. The contractor shall stabilize all areas of exposed soil, rock, or other material that is susceptible to erosion. The contractor shall use the following methods and materials to stabilize the exposed areas:

1. Permanent seeding shall be used on all areas of exposed soil, rock, or other material that is susceptible to erosion. The contractor shall use the following methods and materials to stabilize the exposed areas:
2. The contractor shall use a minimum of 100 lbs of seed per 1000 sq ft of exposed area.
3. The contractor shall use a minimum of 100 lbs of straw per 1000 sq ft of exposed area.
4. The contractor shall use a minimum of 100 lbs of mulch per 1000 sq ft of exposed area.

**42) DISTURBED AREA STABILIZATION (W/TEMPORARY SEEDING)**

1. The contractor shall stabilize all areas of exposed soil, rock, or other material that is susceptible to erosion. The contractor shall use the following methods and materials to stabilize the exposed areas:

1. Temporary seeding shall be used on all areas of exposed soil, rock, or other material that is susceptible to erosion. The contractor shall use the following methods and materials to stabilize the exposed areas:
2. The contractor shall use a minimum of 100 lbs of seed per 1000 sq ft of exposed area.
3. The contractor shall use a minimum of 100 lbs of straw per 1000 sq ft of exposed area.
4. The contractor shall use a minimum of 100 lbs of mulch per 1000 sq ft of exposed area.

**Storm Drain Outlet Protection**

1. The contractor shall stabilize all areas of exposed soil, rock, or other material that is susceptible to erosion. The contractor shall use the following methods and materials to stabilize the exposed areas:

1. Storm drain outlet protection shall be used on all areas of exposed soil, rock, or other material that is susceptible to erosion. The contractor shall use the following methods and materials to stabilize the exposed areas:
2. The contractor shall use a minimum of 100 lbs of protection per 1000 sq ft of exposed area.
3. The contractor shall use a minimum of 100 lbs of straw per 1000 sq ft of exposed area.
4. The contractor shall use a minimum of 100 lbs of mulch per 1000 sq ft of exposed area.

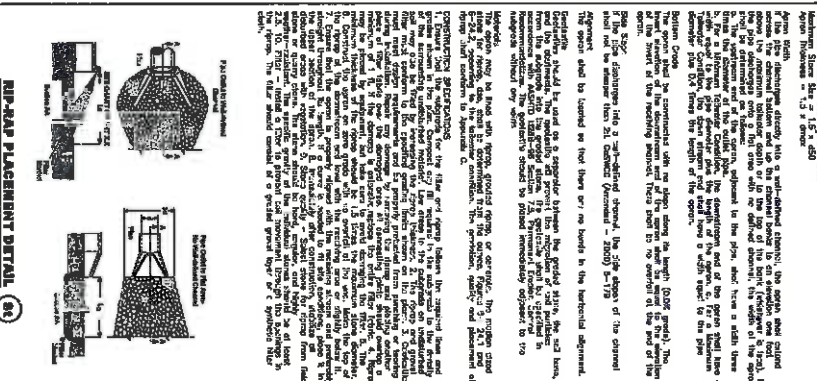

**43) RET. BARRIERS (FENCE, W/ SUPPORTING FRAME)**

1. The contractor shall stabilize all areas of exposed soil, rock, or other material that is susceptible to erosion. The contractor shall use the following methods and materials to stabilize the exposed areas:

1. Retaining barriers shall be used on all areas of exposed soil, rock, or other material that is susceptible to erosion. The contractor shall use the following methods and materials to stabilize the exposed areas:
2. The contractor shall use a minimum of 100 lbs of barrier per 1000 sq ft of exposed area.
3. The contractor shall use a minimum of 100 lbs of straw per 1000 sq ft of exposed area.
4. The contractor shall use a minimum of 100 lbs of mulch per 1000 sq ft of exposed area.

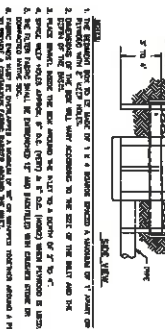

**44) CONSTRUCTION ERT**

1. The contractor shall stabilize all areas of exposed soil, rock, or other material that is susceptible to erosion. The contractor shall use the following methods and materials to stabilize the exposed areas:

1. Construction erosion control shall be used on all areas of exposed soil, rock, or other material that is susceptible to erosion. The contractor shall use the following methods and materials to stabilize the exposed areas:
2. The contractor shall use a minimum of 100 lbs of erosion control per 1000 sq ft of exposed area.
3. The contractor shall use a minimum of 100 lbs of straw per 1000 sq ft of exposed area.
4. The contractor shall use a minimum of 100 lbs of mulch per 1000 sq ft of exposed area.

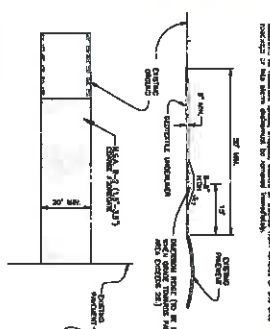

**45) EROSION BARRIERS**

1. The contractor shall stabilize all areas of exposed soil, rock, or other material that is susceptible to erosion. The contractor shall use the following methods and materials to stabilize the exposed areas:

1. Erosion barriers shall be used on all areas of exposed soil, rock, or other material that is susceptible to erosion. The contractor shall use the following methods and materials to stabilize the exposed areas:
2. The contractor shall use a minimum of 100 lbs of barrier per 1000 sq ft of exposed area.
3. The contractor shall use a minimum of 100 lbs of straw per 1000 sq ft of exposed area.
4. The contractor shall use a minimum of 100 lbs of mulch per 1000 sq ft of exposed area.

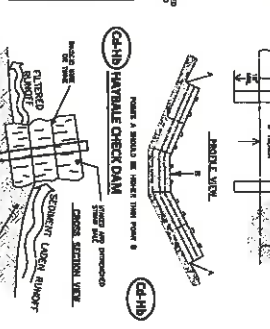
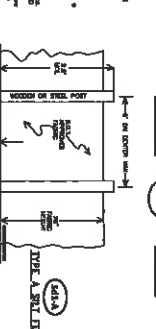
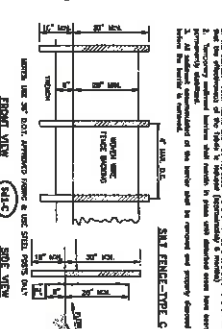

**46) DIVERSION SWALE**

1. The contractor shall stabilize all areas of exposed soil, rock, or other material that is susceptible to erosion. The contractor shall use the following methods and materials to stabilize the exposed areas:

1. Diversion swales shall be used on all areas of exposed soil, rock, or other material that is susceptible to erosion. The contractor shall use the following methods and materials to stabilize the exposed areas:
2. The contractor shall use a minimum of 100 lbs of swale per 1000 sq ft of exposed area.
3. The contractor shall use a minimum of 100 lbs of straw per 1000 sq ft of exposed area.
4. The contractor shall use a minimum of 100 lbs of mulch per 1000 sq ft of exposed area.

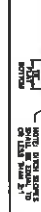

**47) GRASSSED SWALE**

1. The contractor shall stabilize all areas of exposed soil, rock, or other material that is susceptible to erosion. The contractor shall use the following methods and materials to stabilize the exposed areas:

1. Grassed swales shall be used on all areas of exposed soil, rock, or other material that is susceptible to erosion. The contractor shall use the following methods and materials to stabilize the exposed areas:
2. The contractor shall use a minimum of 100 lbs of grass per 1000 sq ft of exposed area.
3. The contractor shall use a minimum of 100 lbs of straw per 1000 sq ft of exposed area.
4. The contractor shall use a minimum of 100 lbs of mulch per 1000 sq ft of exposed area.

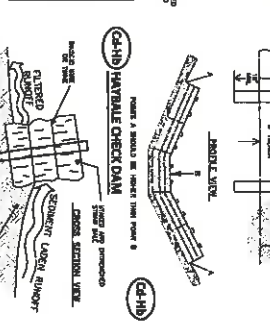
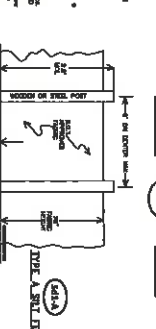
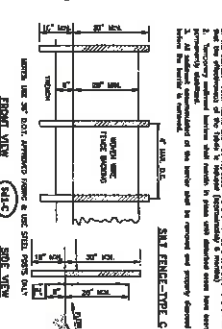

**EROSION CONTROL BMP DETAILS**

Moore Street Sidewalk  
Oxford, Newton County, Georgia

**City of Oxford  
Construction Change Order Form**

PROJECT NAME: Asbury Park PAGE: 1  
 CONTRACTOR: HCS Services, LLC; Hule Stewart DATE: 12/26/2018  
 ENGINEER: Robert Jordan, Jordan Engineering CHANGE ORDER NO.: 2  
 INSPECTOR: Jody Reid, City of Oxford

BID TAB ITEM NO.	DESCRIPTION AND UNITS (Change Order Log #)	QUANTITY	UNIT	UNIT COST	AMOUNT	ADDED DAYS
	DECREASE QUANTITY					
	INCREASE QUANTITY					
	NEW ITEMS					
N/A	#3 stone stabilization for pavillion base (10 feet outside pavillion foundation)	534	TN	\$40.00	\$ 21,360.00	10
N/A	Filter fabric geotextile above stone base beneath pavillion area (5400 sf @ \$0.19/sf)	1	LS	\$1,000.00	\$ 1,000.00	0
SUBTOTAL THIS PAGE						\$ 22,360.00
SUBTOTAL OTHER PAGES						N/A
COMBINED TOTAL						\$ 22,360.00

In consideration of the Change Order agreed to herein as complete equitable adjustments and full and final payment for the Contractor's additional work, the Contractor hereby releases the Owner from liability under this contract for further equitable adjustments, including additional time for performance, attributable to such facts or circumstances giving rise to the proposal for adjustment.

**Hule Stewart** \_\_\_\_\_ **Date** \_\_\_\_\_  
 HCS Services, LLC representative

% PRICE CHANGE THIS CHANGE ORDER 3.05%  
 PREVIOUS CHANGE ORDER(S) 10/18/2018 C.O. #1 10/18/2018  
 CHANGE ORDER(S) 1.60%  
 CHANGE ORDER(S) TO DATE 4.65%  
 ORIGINAL CONTRACT PRICE/DAYS \$ 733,685.00 180  
 ORIGINAL CONTRACT PRICE/DAYS PLUS CHANGE ORDER(S) \$ 767,812.75 191

**Matt Pepper**, City Manager \_\_\_\_\_ **Date** \_\_\_\_\_  
 City of Oxford representative

  
1-3-19  
**Robert Jordan** \_\_\_\_\_ **Date** \_\_\_\_\_  
 Engineer's representative

# City of Oxford - Construction Change Order Form

PROJECT NAME: N. Emory Sewer Extension

CONTRACTOR: Site Engineering, Inc.

ENGINEER: Robert Jordan, Jordan Engineering

INSPECTOR: Jack Reed, City of Oxford

PAGE: 1  
 DATE: 10/18/2018  
 CHANGE ORDER NO.: 1

BID ITEM NO.	DESCRIPTION AND UNITS (Change Order Log #)	QUANTITY	UNIT	UNIT COST	AMOUNT	ADDED DAYS
	DECREASE QUANTITY					
	INCREASE QUANTITY					
1	Rock Excavation/Removal (100 LF x 8' width x 8' depth; sta 8+25 to sta 9+25)	92	CY	\$120.00	\$ 11,040.00	5
	NEW ITEMS					

In consideration of the Change Order agreed to herein as complete equitable adjustments and final payment for the Contractor's additional work, the Contractor hereby releases the Owner from liability under this contract for further equitable adjustments, including additional time for performance, appropriate to such work or circumstances giving rise to the proposed for adjustment.

Date: 12/18/18  
 Site Engineering, Inc. representative

Date: 12-18-18  
 City of Oxford representative  
 Robert Jordan  
 Engineer's representative

SUBTOTAL THIS PAGE \$ 11,040.00 5  
 SUBTOTAL OTHER PAGES N/A N/A  
 COMBINED TOTAL \$ 11,040.00 5

% PRICE CHANGE THIS	1.50%	PRICE CHANGE	
CHANGE ORDER PREVIOUS	0.00%	DATE	5
CHANGE ORDER(S) TO DATE	1.50%	DATE	5
ORIGINAL CONTRACT PRICE/DAYS		DATE	180
PLUS CHANGE ORDER(S)		DATE	185



October 31, 2018

City of Washington, Georgia  
Attn: Honorable Ames M. Barnett, Mayor  
102 E. Liberty Street  
Washington, GA 30673

City of Oxford, Georgia  
Attn: Honorable Jerry D. Roseberry, Mayor  
110 West Clark Street  
Oxford, GA 30054

**Re: MEAG Power Sale of Excess Reserve Capacity to the City of Oxford  
on Behalf of the City of Washington**

Dear Mayor Barnett and Mayor Roseberry:

This Letter Agreement sets forth the agreement between the Municipal Electric Authority of Georgia ("MEAG Power"), City of Washington, Georgia ("Washington"), and the City of Oxford, Georgia ("Oxford") for MEAG Power's sale on behalf of Washington of certain excess reserve capacity to Oxford pursuant to Section 312 of the Power Sales Contract between MEAG Power and Washington. MEAG Power is willing to facilitate and execute this transaction pursuant to Section 312, subject to this Letter Agreement.

The capitalized words or terms that are used in this Letter Agreement, but are not defined herein, shall have the same meanings as assigned to them in the Power Sales Contract.

In consideration of the mutual agreements set forth herein, the sufficiency and adequacy of which are acknowledged by MEAG Power, Washington and Oxford, it is understood and agreed that:

**(1) Sale of Excess Reserve Capacity by MEAG Power on Behalf of Washington.**

**(a)** Pursuant to Section 312 of the Power Sales Contract between MEAG Power and Washington, Washington has declared capacity in the amount of 1,044 kW, as measured at B1, of the total kW of its Project One Entitlement Share (the "Sales Amount") to be excess to its needs. Washington has requested MEAG Power to sell, and MEAG Power shall, in accordance with this Letter Agreement, sell this capacity, but no energy associated therewith, to Oxford.

**(b)** This Sale Amount shall not reduce Washington's cost obligations under the Power Sales Contract and Washington shall remain liable to MEAG Power for its entire Entitlement Share. All payments received by MEAG Power from Oxford for the Sale Amount pursuant to this Letter Agreement shall be credited to Washington's obligation to MEAG Power to pay for its Entitlement Share.

Municipal Electric Authority of Georgia  
1470 Riveredge Parkway NW  
Atlanta, Georgia 30328-4640

1-800-333-MEAG 770-563-0300



(2) **Purchase of Excess Reserve Capacity by Oxford.** Oxford agrees to purchase the Sale Amount for a price of \$2.00 per kW-year (the "Contract Price"). MEAG Power shall bill Oxford for such amount and Oxford shall pay all amounts due in the same manner as other payments under the Power Sales Contract between MEAG Power and Oxford.

(3) **Costs.** Washington shall be obligated for all costs incurred by MEAG Power as a direct result of the transaction identified in this Letter Agreement. MEAG Power agrees to provide sufficient documentation to Washington to enable it to verify any such costs.

(4) **Indemnification.** Washington hereby indemnifies and holds MEAG Power and the remaining MEAG Power Participants harmless from and against any and all losses, costs, liabilities, damages, expenses (including without limitation attorneys' fees and expenses) of any kind and incurred or suffered by MEAG Power or its Participants as a result of, or in connection with, Washington's sale of excess reserve capacity pursuant to this Letter Agreement.

(5) **Term.** The initial term of the sale of Washington's excess reserve capacity to Oxford pursuant to this Letter Agreement shall begin at 0000 hours on January 1, 2019 and end at 2400 hours on December 31, 2019. Other than as to the sales transaction, all other provisions of the agreement shall remain in effect until all other obligations under this Letter Agreement are satisfied, including, but not limited to, Washington's obligation to indemnify MEAG Power and the Participants. All times referenced herein are Central Prevailing Time.

(6) **Termination and Unwind.** If MEAG Power changes its policy concerning the computation of necessary reserve capacity from a "budgeted coincident peaks" standard to an "actual peaks" standard and such policy change goes into effect during the Term of this Letter Agreement, Washington and Oxford shall be returned to their respective positions as if this Letter Agreement had not been entered into (e.g., Oxford shall receive a credit for amounts it paid pursuant to this Letter Agreement and Washington shall be billed for all such amounts). Subsequently, this Letter Agreement shall terminate, except that Sections (3) and (4) shall remain effective.

If you are in agreement with the foregoing and after this Letter Agreement has been duly authorized by the respective governing bodies of Washington and Oxford, please execute this Letter Agreement in the space provided below.

**MUNICIPAL ELECTRIC AUTHORITY OF GEORGIA**

ATTEST:

\_\_\_\_\_

By: \_\_\_\_\_  
James E. Fuller  
President and Chief Executive Officer

[SIGNATURES CONTINUED ON NEXT PAGE]

Municipal Electric Authority of Georgia  
1470 Riveredge Parkway NW  
Atlanta, Georgia 30328-4640

1-800-333-MEAG 770-563-0300



Agreed to and accepted, this 9 day  
of November 2008  
Month Year

**CITY OF WASHINGTON**

By: Shari D. Bailey

ATTEST:

Debbie Danner  
City Clerk

[SEAL]

Agreed to and accepted, this \_\_\_\_ day  
of \_\_\_\_\_, \_\_\_\_  
Month Year

**CITY OF OXFORD**

By: \_\_\_\_\_

ATTEST:

\_\_\_\_\_  
City Clerk

[SEAL]